

C O R P O R A T E
B R O C H U R E



ABOUT ORIOM GROUP

Oriom Group is a diversified business conglomerate with a strong presence across core industrial and infrastructure-driven sectors. Built on a foundation of innovation, reliability, and long-term vision, the group operates through multiple verticals including Steel & Power, Chemicals, Refractories, and Real Estate.

With a strategic focus on nation-building industries, Oriom Group has established itself as a trusted name by delivering high-quality products and services that power critical sectors of the economy. The group's integrated approach enables seamless synergy between its businesses, ensuring efficiency, sustainability, and consistent growth.

OUR BUSINESS VERTICALS



STEEL & POWER

Forging strength and powering progress.



CHEMICALS

Advanced chemistry for modern industry.



REFRACTORIES

Enduring performance under extreme conditions.



REAL ESTATE

Building spaces that shape tomorrow.



OUR BUSINESS VERTICALS

STEEL & POWER

Oriom Group plays a significant role in the steel and energy sector through companies like Jai Hanuman Udyog Ltd., BR Steel Power Pvt. Ltd., and Neotech Specialty Structures. The division focuses on producing high-grade steel and supporting infrastructure development with reliable power solutions.

CHEMICALS

Through its chemical vertical, including Fortis Chemicals Pvt. Ltd., Arosolv Distillates Pvt. Ltd., and Utkal Hydrocarbon, the group delivers advanced chemical solutions. These companies specialize in industrial chemicals, solvents, and hydrocarbon products, catering to diverse industrial requirements with a commitment to quality and safety.

REFRATORIES

In the refractory segment, Oriom Group operates through Koshal Ceramics Pvt. Ltd. and Microcosm Reframin Pvt. Ltd., offering high-performance refractory materials essential for high-temperature industrial processes. This vertical supports industries such as steel, cement, and manufacturing with durable and efficient solutions.

REAL ESTATE

Oriom Realty represents the group's presence in the real estate sector, focusing on developing modern, sustainable, and value-driven residential and commercial spaces that align with evolving urban needs.

INTRODUCING NEOTECH

Precision. Capacity. Reliability.

- Strengthening its position in the steel industry through a strong commitment to quality and engineering excellence, the Group strategically expanded into the Pre-Engineered Buildings (PEB) and Structural Steel Fabrication sector through the acquisition and enhancement of a state-of-the-art manufacturing facility originally established by the RALCO Steels Pvt. Ltd., Dubai.
- Our operations are associated with the earlier and highly experienced setup of RALCO Steels Pvt. Ltd., under which substantial PEB and structural steel projects were successfully executed over the years. The existing expertise, manufacturing capabilities, technical workforce, and execution systems developed through the RALCO setup now continue to operate under NEOTECH in a more organized, modernized, and expanded manner.
- Located at Bobbili, Vizianagaram District, Andhra Pradesh in 20 Acres with 12,000 SQM of Covered area, the facility has an annual production capacity of 50,000 MT, enabling NEOTECH to undertake large-scale industrial, infrastructure, and commercial projects efficiently.
- At NEOTECH, we provide complete turnkey solutions covering every stage of project execution, from concept and design to fabrication, supply, erection, and final installation.
- In addition, NEOTECH is an RDSO-certified company and approved Vendor of BHEL, reinforcing our commitment to stringent quality standards, compliance, and excellence in railway and infrastructure-related projects.

VALUES



INTEGRITY

Honesty in every action and process



QUALITY

One Step ahead always



COMMITMENT

Sticking to deliverables as agreed.



PASSION

Professionalism with energized actions

SAFETY FIRST

Health & Safety

- Mandatory use of Personal Protective Equipment (PPE) at site. Regular site inspections and safety control measures implemented.
- Toolbox Talks, Permit-to-Work systems, and Job Safety Analysis (JSA) conducted before critical activities.
- Strict safety procedures followed for Working at Height with special permits and safety equipment.
- Proactive measures taken to prevent accidents and occupational hazards.
- Daily safety briefings conducted for workers at site.
- Safety activities monitored by a competent Safety Officer.
- Regular on-site training conducted on:
 - i. Safety Induction
 - ii. Toolbox Talks
 - iii. Housekeeping
 - iv. Height Work Safety
 - Electrical Safety
 - Material Handling & Lifting Safety



QUALITY ASSURANCE

- Raw material from reputed mills
- Welding
- Dye Penetrant Test (DP Test)
- Ultrasonic Test (UT)
- Paint
- Dry Film Thickness verification
- All quality requirement comply with client requirement



Visual Inspection & Dimension Check



DP Test (Dye Penetrant Test)



UT Test (Ultrasonic Testing)



DFT Paint Verification

SERVICES OFFERED

DESIGN & ENGINEERING (PEB)

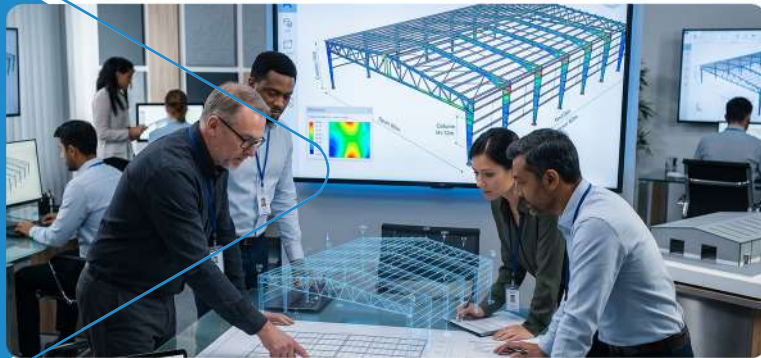

FABRICATION (PEB & STRUCTURAL STEEL)



SUPPLY (PEB & STRUCTURAL STEEL)



ERECTION & INSTALLATION (PEB)



PRIMARY FRAMING SYSTEM

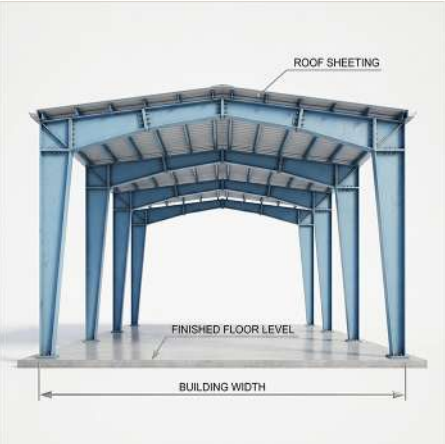

CLEAR SPAN BUILDING

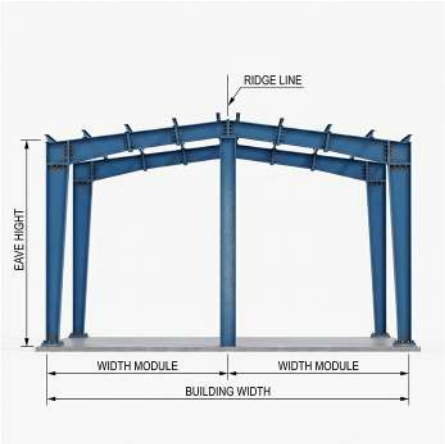

MULTI SPAN BUILDING - 1



MONO SLOPE BUILDING

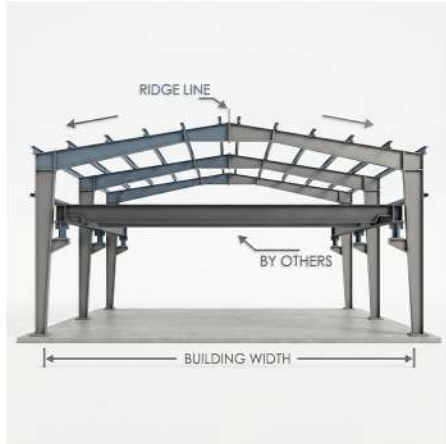

CLEAR SPAN WITH CRANE



MULTI SPAN BUILDING - 2



RAFTER SYSTEM

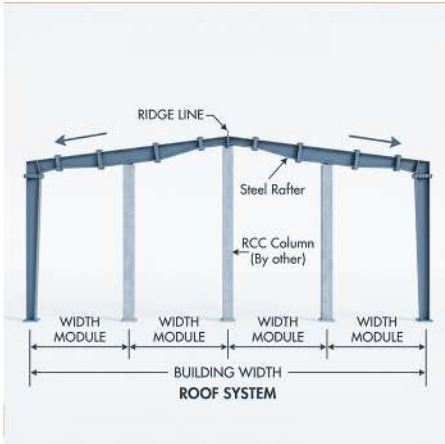

MULTI SPAN BUILDING - 3



LEAN - TO

SECONDARY FRAMING SYSTEM

TECHNICAL SPECIFICATIONS - BRACKET SERIES 'A'

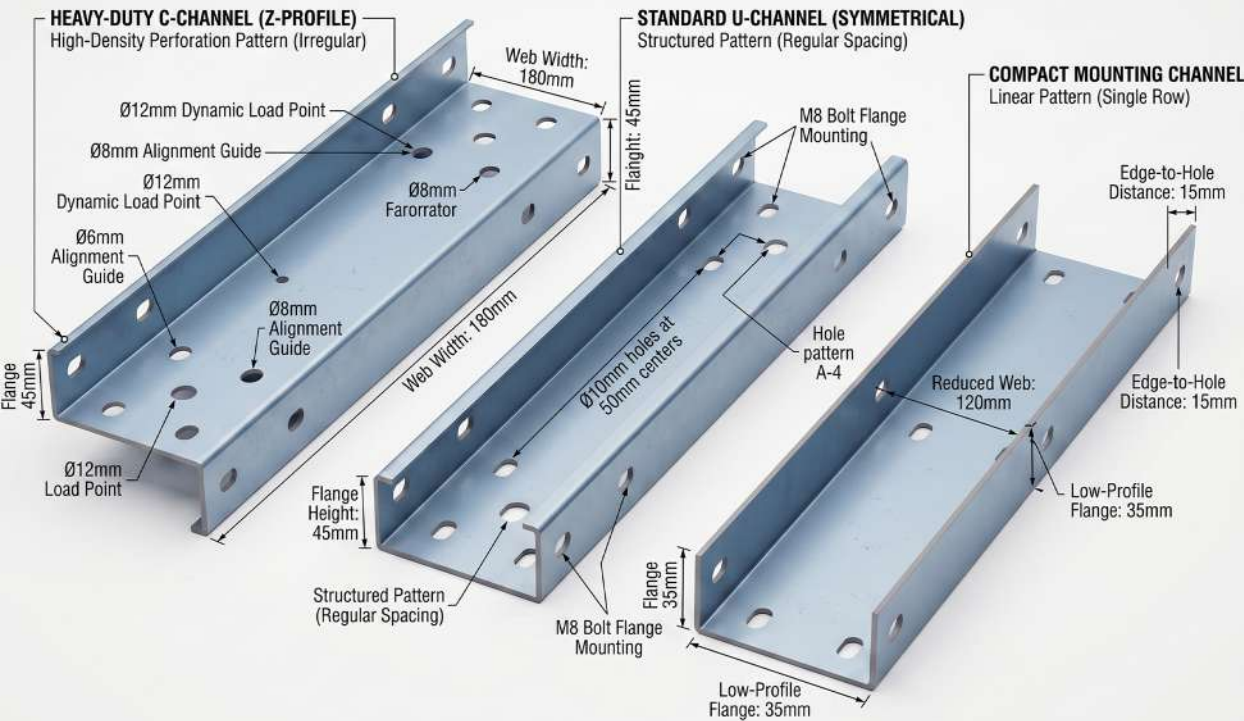

Material: ASTM A36 Galvanized Steel, 5mm Gauge
Coating: Hot-Dip Galvanized Z275
Finish: Satin, Passivated

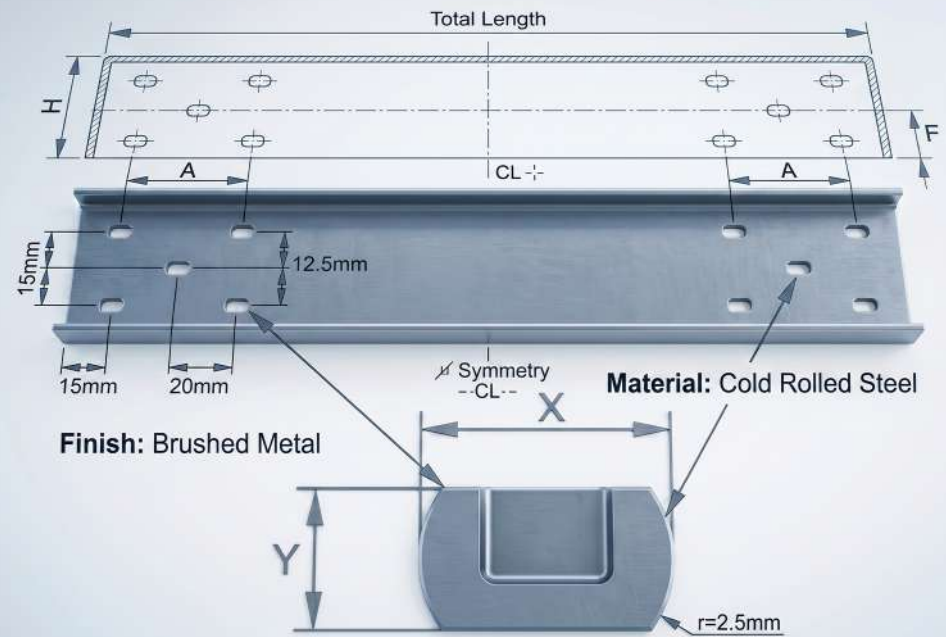

Punch and Pattern Details
(Typical, Symmetrical)

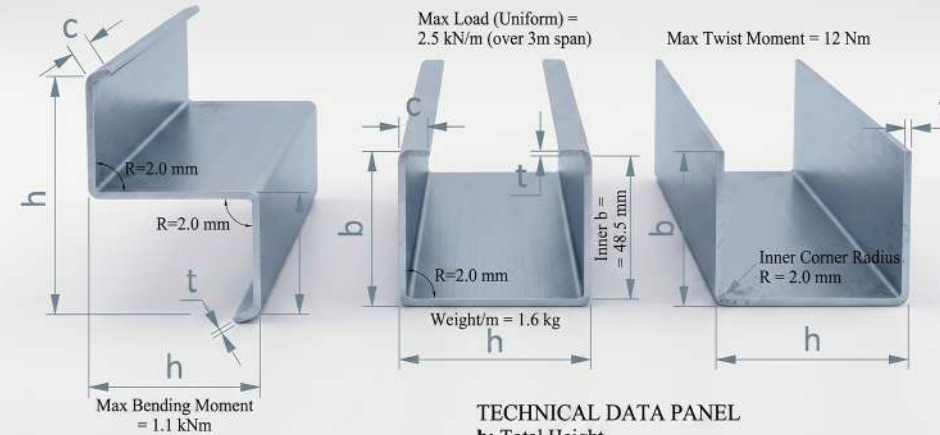

TECHNICAL DATA PANEL

h: Total Height
b: Flange Width (base for C, top/bottom for Z, base for U)
c: Flange Return (Lip) for the 'C' profile
t: Material Thickness (0.75 mm / 22 GA)
Material: Galvanized Steel DX51D (e.g., used for purlins)
Density (ρ): 7850 kg/m³

CRANE SYSTEM

TOP RUNNING CRANE ALONG BUILDING LENGTH

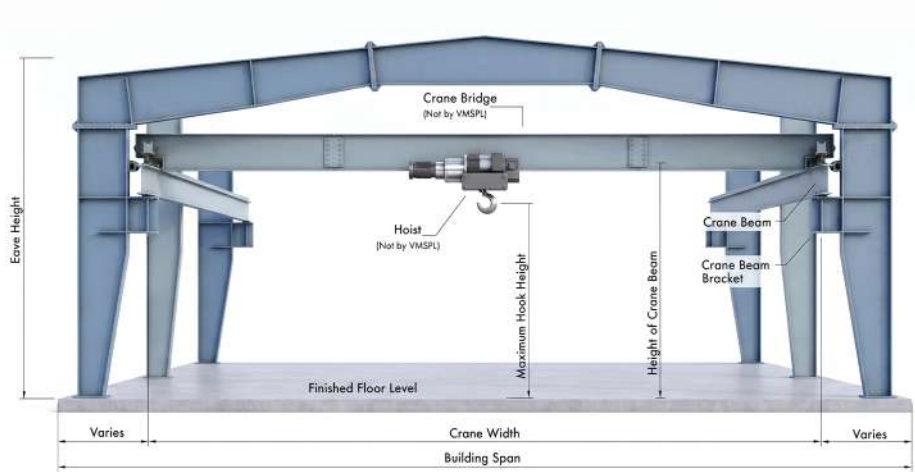

JIB CRANE & MONORAIL CRANE

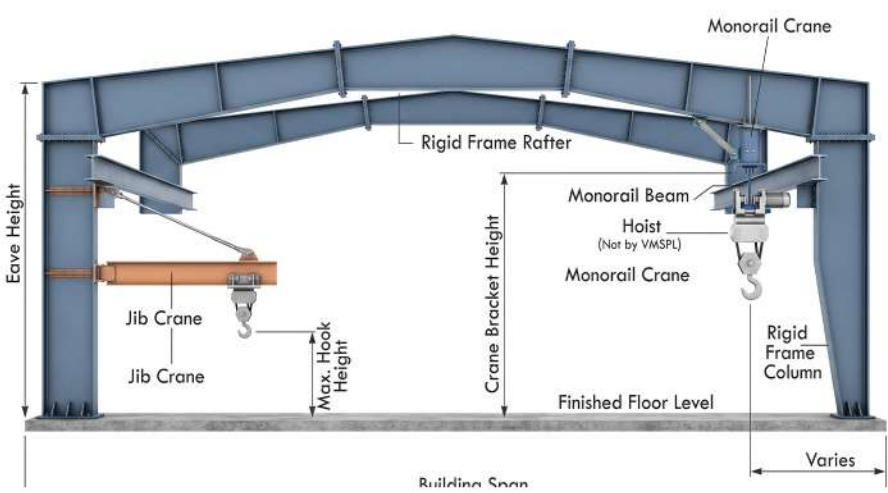

UNDERHUNG CRANE

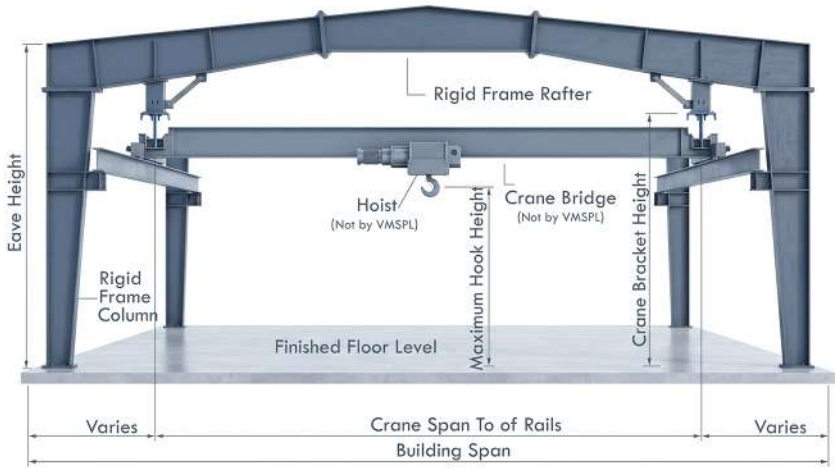

DECK SHEETING

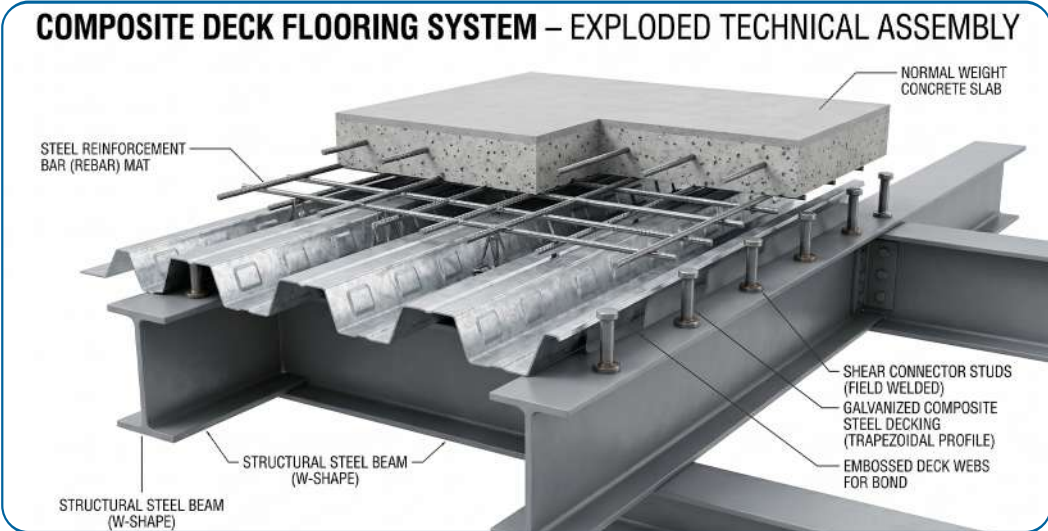

ROOFING SYSTEM

STANDING SEEM ROOF ASSEMBLY

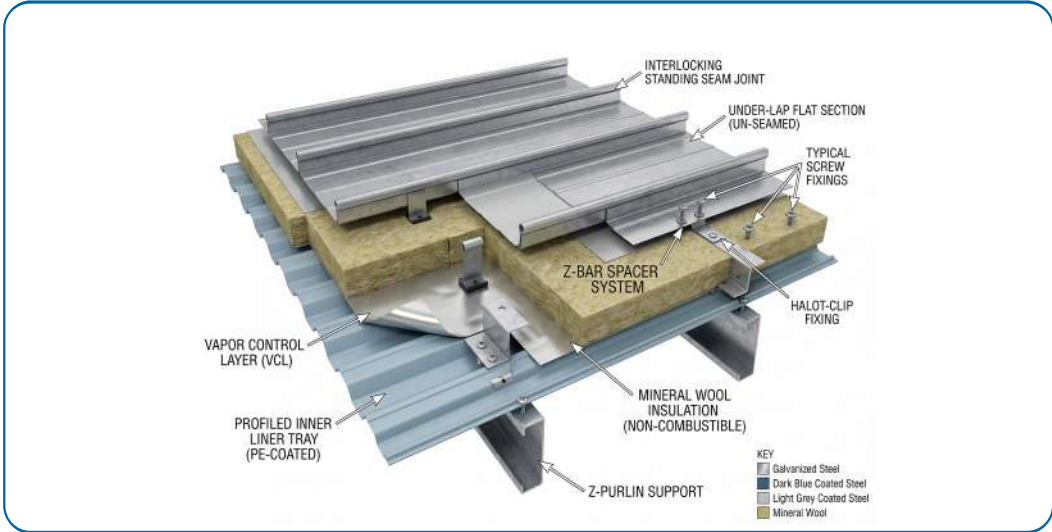

STANDING SEEM ROOF INSTALLATION



STANDING SEEM ROOF INSTALLATION



STANDING SEEM ROOF TOP VIEW



HI-RIB AND WALL SHEET

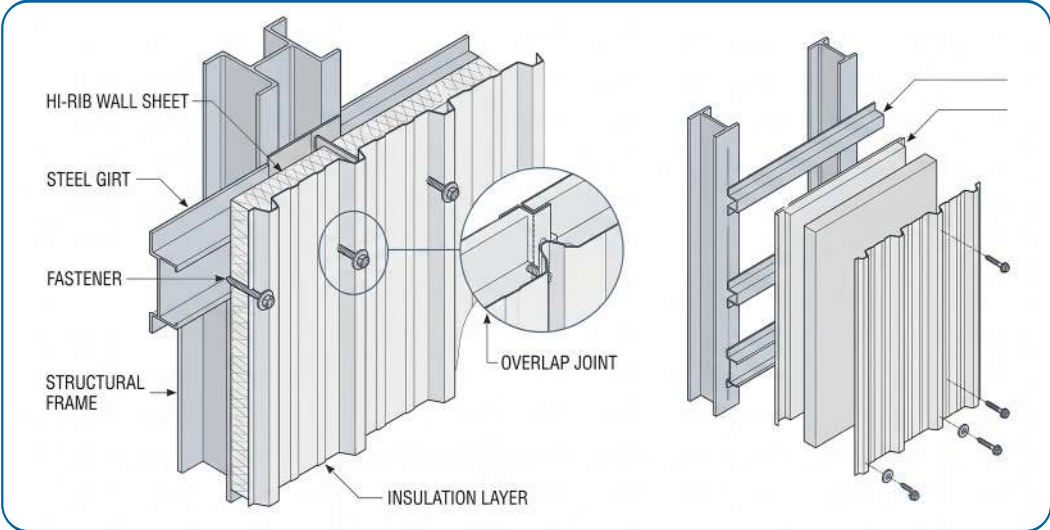

SANDWICH PANELS

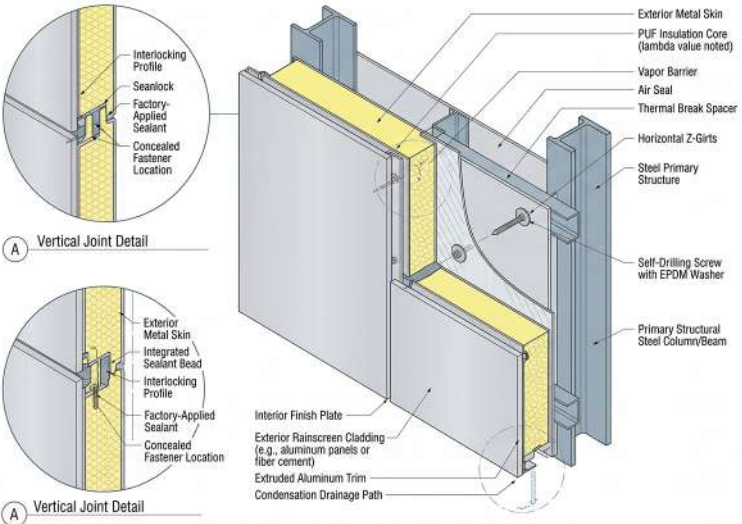
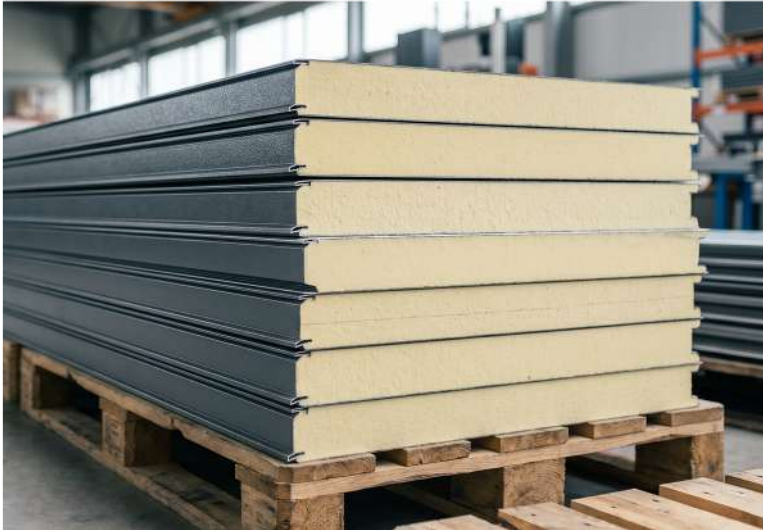
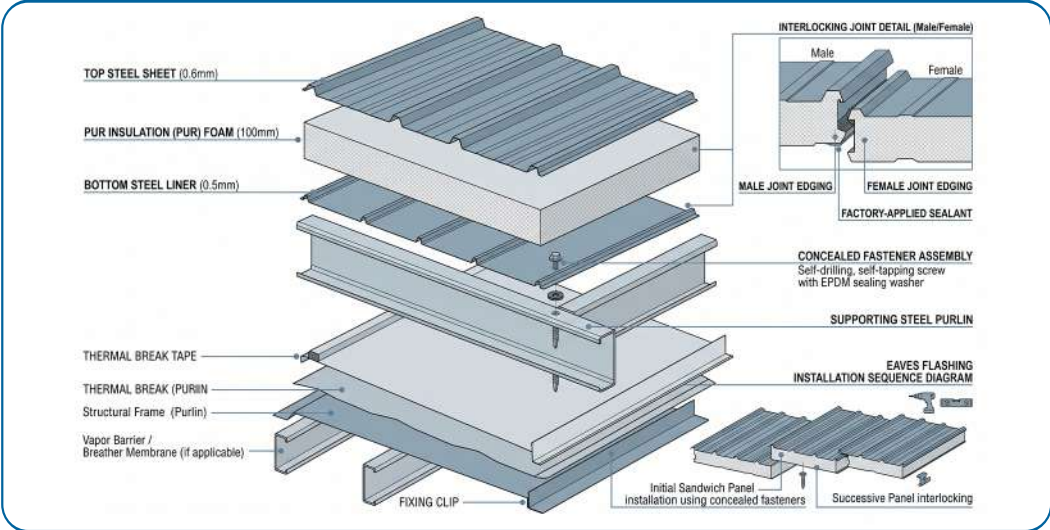

FLASHING & ACCESSORIES

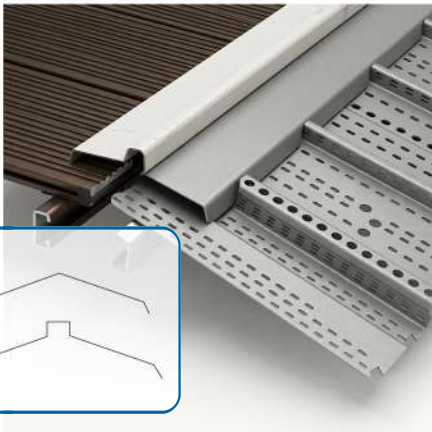

RIDGES

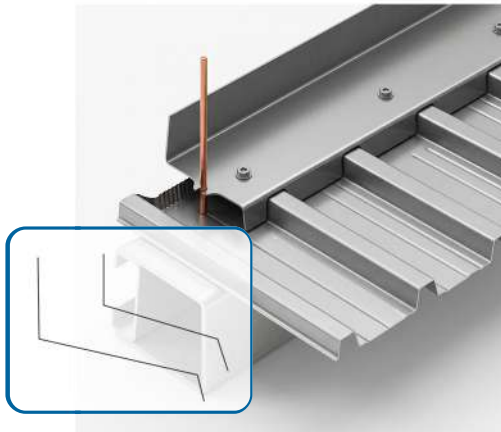

APRON FLASHING

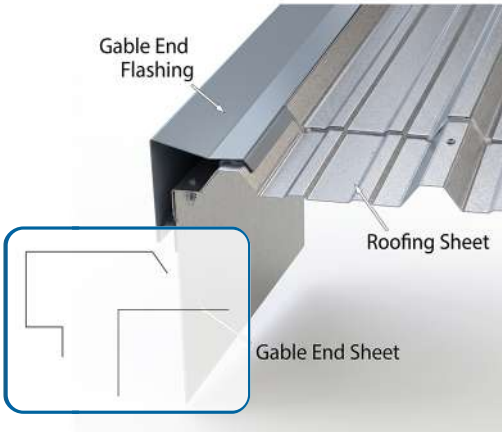

BARGE BOARD (GABLE END FLASHING)

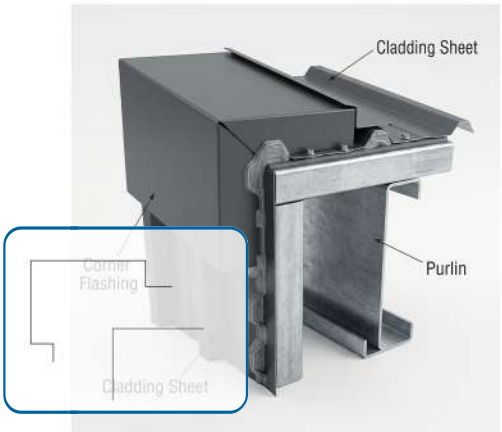

CORNER FLASHING

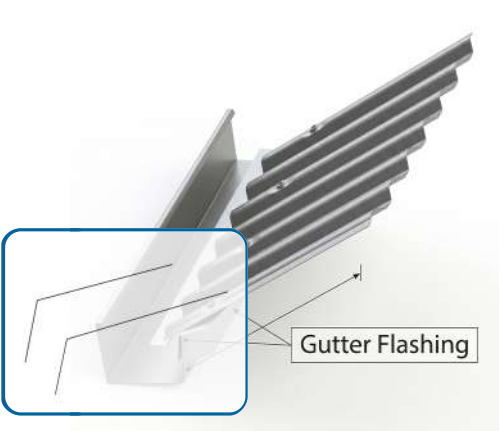

GUTTER FLASHING

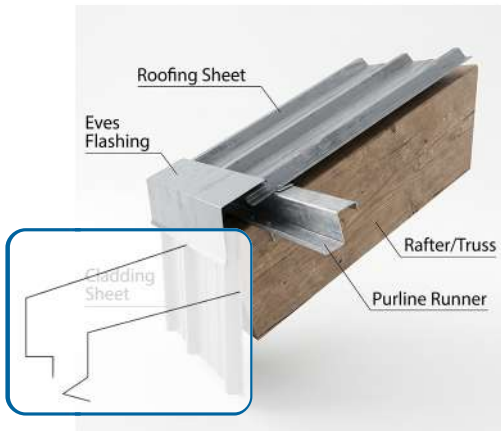

EVES FLASHING

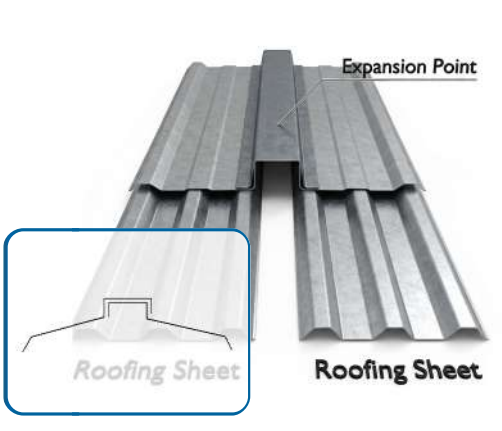

EXPANSION JOINT (IN TWO PIECES)

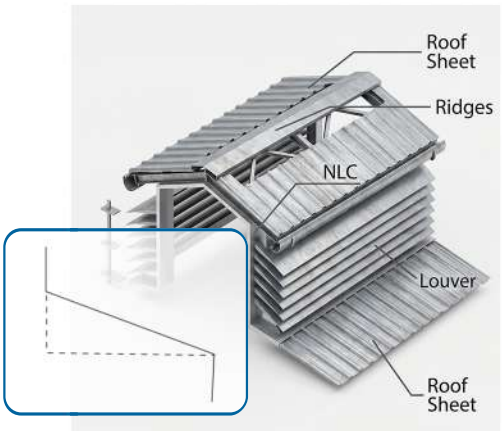

S-TYPE LOUVERS

FLASHING & ACCESSORIES



WALL FLASHING

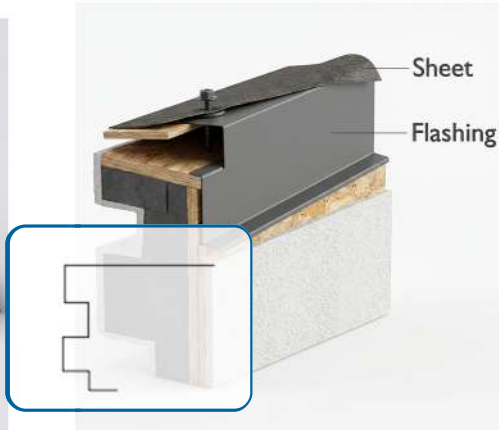

FACIAL FLASHING

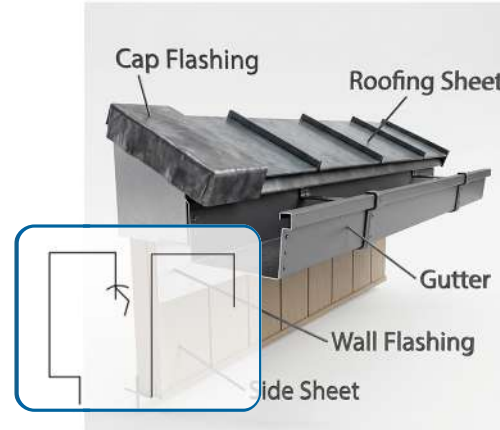

CAP FLASHING

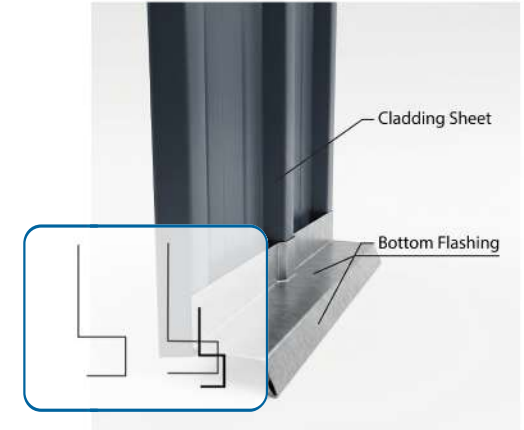

CLADDING BOTTOMFLASHING

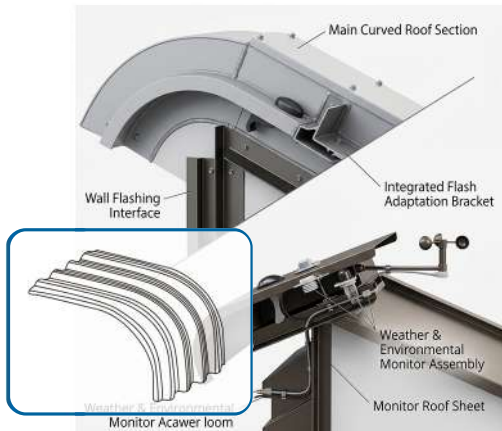

NORTH LIGHT CURVE

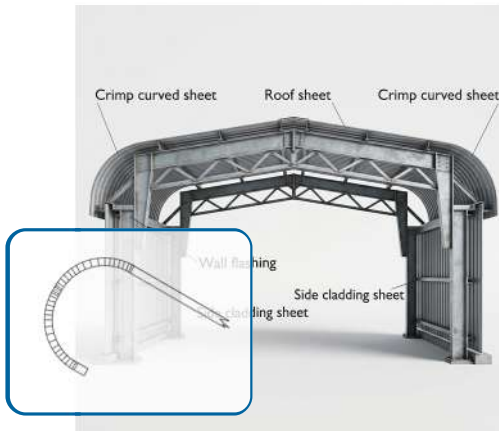

ROOF CRIMPPED CURVED SHEET

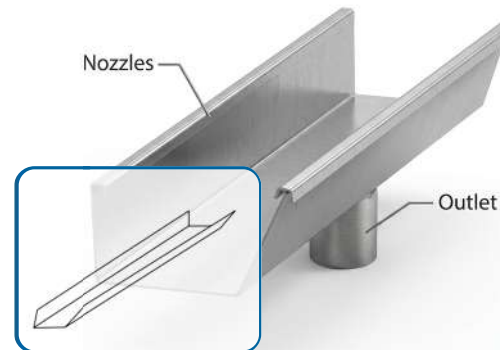

VALLEY GUTTERS

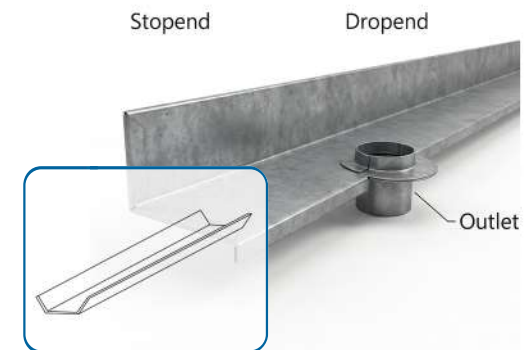

EAVES GUTTERS

SEGMENTS WE SERVE



INDUSTRIAL PLANTS

We cater to manufacturing plants, processing units, and heavy engineering facilities.



COMMERCIAL WAREHOUSING

We fabricate structural systems for warehouses, logistics parks, and storage facilities with scalable and efficient designs.



INFRASTRUCTURE PROJECTS

Our fabrication solutions support infrastructure development such as bridges, metro structures, and public utility projects.

SEGMENTS WE SERVE



POWER & ENERGY SECTOR

We provide structural steel solutions for power plants, renewable energy projects, and transmission infrastructure.



COMMERCIAL BUILDINGS

Our expertise covers commercial complexes, showrooms, and multi-use buildings requiring both structural strength and aesthetic integration.



OIL & GAS / PROCESS PLANTS

We support fabrication requirements for process industries, including refineries and material handling structures.



CUSTOMIZED STRUCTURAL SOLUTIONS

We also undertake specialized and tailor made fabrication works based on unique client requirements across sectors.

OUR MANUFACTURING EXCELLENCE



COMPREHENSIVE STRUCTURAL FABRICATION

We deliver end-to-end fabrication of structural steel components, including columns, rafters, beams, trusses, and complex built-up sections.

PRECISION CUTTING & PROCESSING

Our facility is equipped with CNC plasma cutting systems and high-capacity shearing machines, ensuring dimensional accuracy and consistent quality.

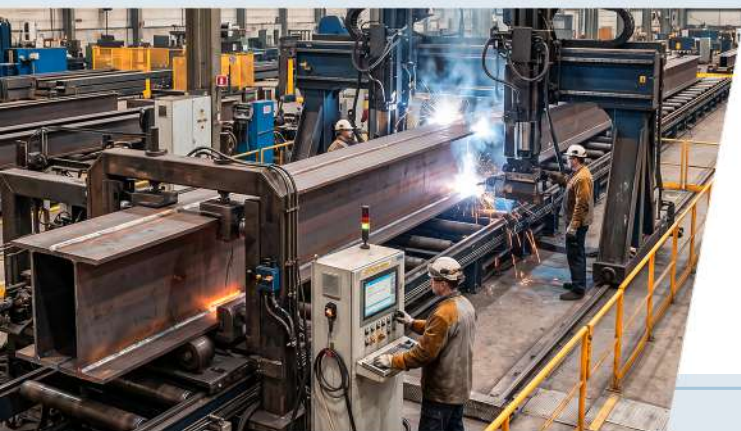

AUTOMATED BEAM BUILT-UP SYSTEMS

A semi-automated beam built-up line enables us to manufacture customized H-beams and heavy sections with high precision and efficiency.

OUR MANUFACTURING EXCELLENCE



ADVANCED WELDING CAPABILITIES

We employ qualified welders and controlled welding processes, including MIG welding, to ensure strong and reliable joints

FIT-UP, ASSEMBLY & DIMENSIONAL CONTROL

Structured fit-up practices and stringent dimensional checks ensure alignment accuracy and ease of site erection.



SURFACE PREPARATION & FINISHING READINESS

All fabricated components undergo thorough surface preparation to ensure proper coating adhesion and long-term durability.

OUR MANUFACTURING EXCELLENCE



HIGH-VOLUME PRODUCTION CAPABILITY

With an installed capacity of approximately 4200 MT per month, we are equipped to execute large-scale projects within committed timelines.

CUSTOM ENGINEERING & PROJECT ADAPTABILITY

We provide flexible fabrication solutions tailored to project-specific design complexity and execution schedules.



LIST OF EXECUTED PROJECTS

- 01 ANNAND METAL ROOFING
- 02 ANDHRA MULTIPLEX
- 03 ASSAM DETENTION CENTER
- 04 ADITYA ENTERPRISES
- 05 BALAJI AGRO GUNTUR
- 06 JSR ASSOCIATES
- 07 LIVAX PLASTICS
- 08 LENIRA POLYMERS
- 09 MOHAN SPINTEX
- 10 MITS MEGA FOOD PARK RAIGADA
- 11 MUSKAN INDIA
- 12 MGR MODERN RICE MILL
- 13 NARAYANI ISPAT
- 14 OLAM AGRO GAJAPATHINAGARAM
- 15 ROOFTECH PARAWADA
- 16 SILLARIS ROTOMAS
- 17 VSR ASSOCIATES
- 18 VISAKHA DISTILLARIES
- 19 VAULT AGRI TECH Pvt Ltd
- 20 VILLMAR AGRO POLIMERS



ENGINEERING **STANDARDS** & DESIGN COMPLIANCE

Design of Building(s)

The building(s) included in this Proposal will be designed and manufactured in accordance with following Codes: [IS Or AISC/ MBMA]

IS: 800 2007 (HR/Built-Up)

IS: 801 (Cold Form)

AISC: 360-2010 & 2016 (HR/Built-Up)

AISI 2001 EDITION UPDATED ON JANUARY 10, 2003 – North American Specification for the Design of Cold-Formed Steel Structural Members, American Iron and Steel Institute.

MBMA 2012 – Metal Building Systems Manual, Metal Building Manufacturers Association.

AWS D1.1/D1.1M 2020 – Structural Welding Code-Steel, American Welding Society.

IS 1893-2002, IS 1893-2015 and IS 1893-2016 code for the Seismic Loads.

IS 875 Part III code for Wind Loads.

ASCE/SEI 7-05 – Minimum Design Loads for Buildings and Other Structures.

MANUFACTURING & ERECTION TOLERANCES – MBMA 2012. Manufacturing & Erection tolerances will be in accordance with Part IV, Section 9-Fabrication Tolerances.

Software used for Design & Detailing: STAAD Pro, AutoCAD, MBS & TEKLA.



STAAD.Pro



AutoCAD

mbs



Tekla®

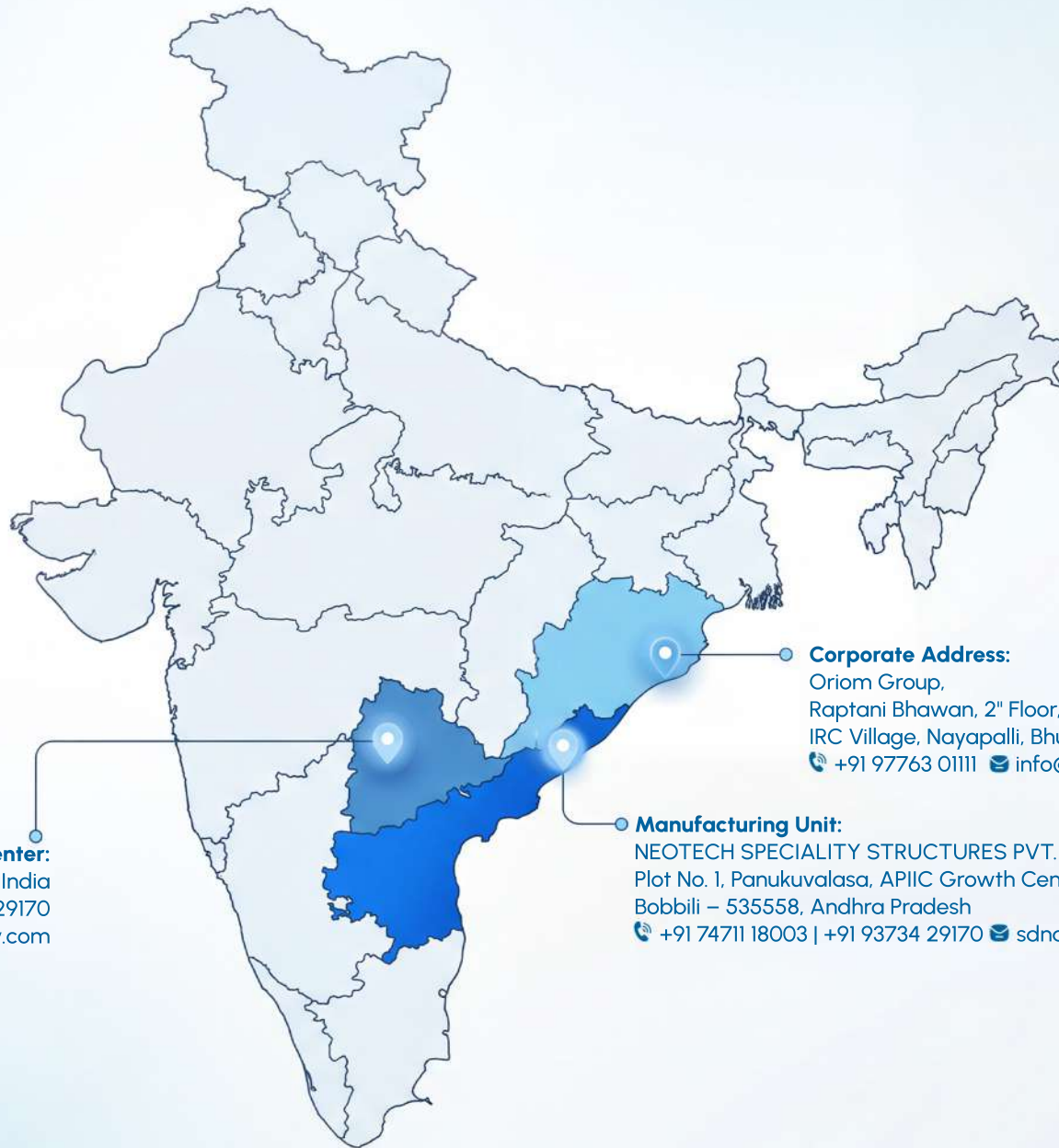

Corporate Address:

Oriom Group,
Raptani Bhawan, 2nd Floor, Indradhanu Market,
IRC Village, Nayapalli, Bhubaneswar (India)
☎ +91 97763 01111 ✉ info@oriomgroup.com

Manufacturing Unit:

NEOTECH SPECIALITY STRUCTURES PVT. LTD.
Plot No. 1, Panukuvalasa, APIIC Growth Centre,
Bobbili – 535558, Andhra Pradesh
☎ +91 74711 18003 | +91 93734 29170 ✉ sdnandagawali@neotechspeciality.com

Design Center:

Hyderabad, India
☎ +91 74711 18003 | +91 93734 29170
✉ sdnandagawali@neotechspeciality.com

Contact Details

www.oriomgroup.com